

FREE INSTALLATION GUIDE

The best way to water plants, trees,
shrubs, hanging baskets, and gardens

All the products in this
Guide are available
online at
www.irrigationdepot.ca



WHAT IS DRIP-IRRIGATION?

A Drip-Irrigation system is a watering system designed to apply water to designated areas, such as gardens, flower beds, container plants, trees, and ground cover.

WHY INSTALL A DRIP-IRRIGATION SYSTEM?

- **Saves Water**—Water is delivered directly to the roots
- **Saves Money**—Up to a 70% reduction in water waste, resulting in lower water bills
- **Saves Time**—Replaces hand watering
- **Healthier Plants**—Plants flourish when receiving the precise amount of water
- **Less Yard Maintenance**—Delivers water to the plants, not to weeds



TABLE OF CONTENTS

SECTION 1	
Before You Begin	Page 4
SECTION 2	
Water Sources	Page 5
SECTION 3	
Connecting to a Hose Faucet	Page 6
SECTION 4	
Common Hose Faucet Projects	
Potted/Hanging Plants.....	Page 8
Ground Cover & Flower Beds.....	Page 10
Small Trees & Shrubs	Page 12
SECTION 5	
Retrofit—Connecting to an Underground Sprinkler System.....	Page 14
SECTION 6	
Common Retrofit Projects	
Container Plants and Shrubs.....	Page 16
Flower Beds, Ground Cover, Shrubs, and Large Plants	Page 19
SECTION 7	
Direct Connection to an Irrigation Valve	Page 22
SECTION 8	
Common Projects	
Gardens	Page 23
Desert Landscaping.....	Page 25
SECTION 9	
Orbit® DripMaster® Parts List	Page 29

IDENTIFY PLANTS WITH SIMILAR WATERING REQUIREMENTS

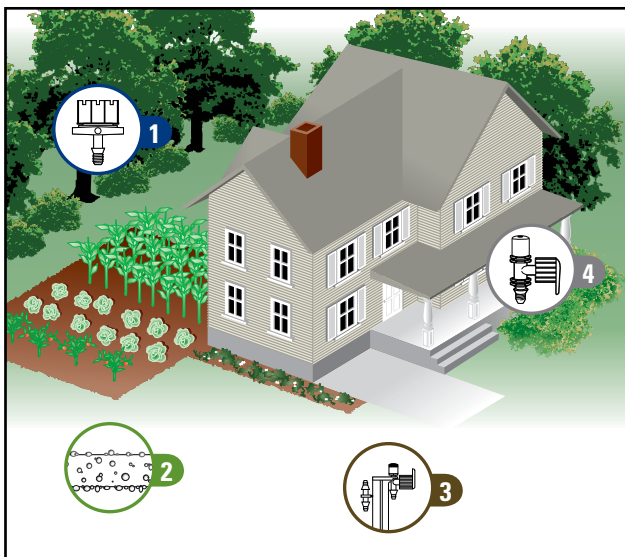

1—TREES & SHRUBS



2—GARDEN



3—GROUND COVER

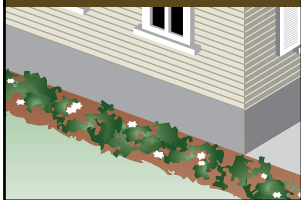

4—POTTED PLANTS



WATER SOURCE AND PRESSURE

Water Source—Drip-Irrigation Systems can be connected to any of the following water sources. Select the best option for you.

- ❑ **1 Outside Hose Faucet**
- ❑ **2 Existing Underground Sprinkler System**
- ❑ **3 Direct Connection to an Irrigation Valve**

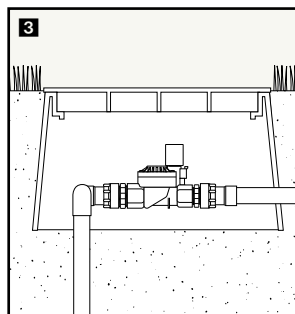
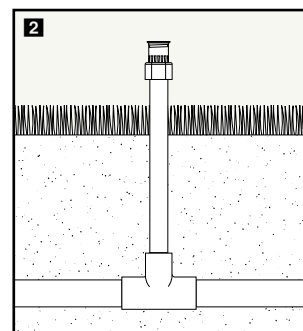
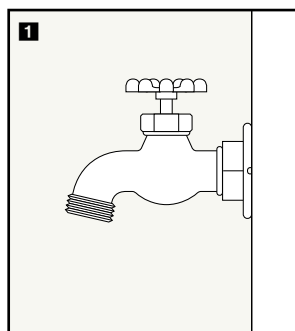

Water Pressure—Obtain a water pressure gauge (available at most home improvement stores) and attach it to your source of water. Drip-Irrigation systems are designed to operate between 15–35 PSI (high water pressure may cause system failure).

PROCEED TO THE APPROPRIATE SECTION

1. **For Hose Faucet Connection**—proceed to the next page.
2. **For Connection to Existing Underground Sprinkler System (Retrofit)**—proceed to page 14.
3. **For Connection to a Designated Irrigation Valve**—proceed to page 22.

CONNECTING TO AN OUTSIDE HOSE FAUCET

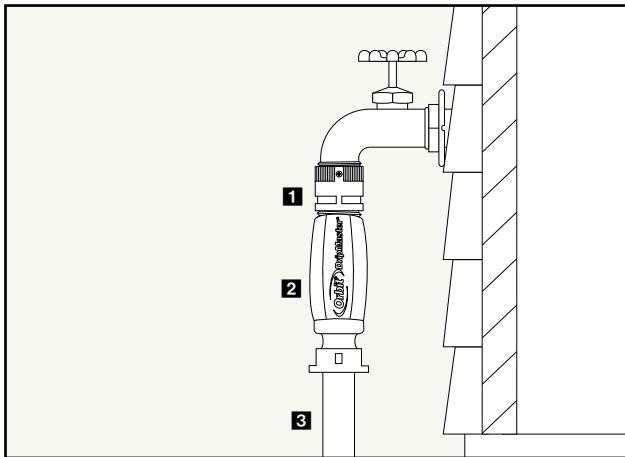

An outside hose faucet is one of the simplest ways to connect your Drip-Irrigation system.

TIP—For complete hands-free watering, install an Orbit Electronic Hose Timer to the hose faucet prior to connecting your Drip-Irrigation system.



The following items are recommended for your hose faucet Drip-Irrigation system:

1 Anti-Siphon

Prevents contaminants from entering your drinking water supply. (Required in most areas). (part # OP-67750)



2 3-in-1 Drip Faucet Connection

A Pressure Regulator (25 PSI), Filter, and 1/2" Drip Tubing Adapter in one. (part # OP-67739)



3 Distribution/Supply Tube The main supply line that feeds water to the Drip-Irrigation system. Distribution Tube may be installed either above or below ground. (part # DR-67346-69346) *TIP— To make installation easier, allow the 1/2" Distribution/Supply Tube to sit in the sun and soften prior to installation.*

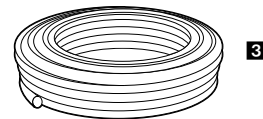

Important: Check local code requirements prior to installing any watering system.

4 Tube End Cap

Plugs the end of the 1/2" Distribution/Supply Tube and serves as a drain for the Drip-Watering system. (part# OP-67462)

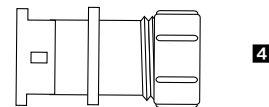

COMMON USES FOR DRIP-IRRIGATION

1. **Potted/Hanging plants**—page 8
 2. **Ground Cover and Flower Beds**—page 10
 3. **Large Plants, Small Trees & Shrubs**—page 12
- Select the application that best matches your needs.

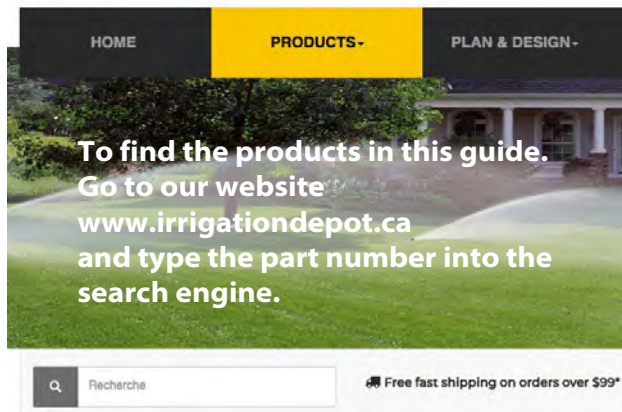

POTTED / HANGING PLANTS

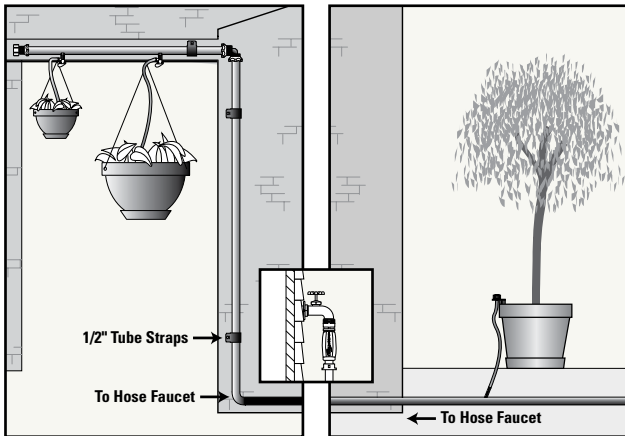

Note: Steps 1–3 apply to both potted & hanging plants

1 Distribution/Supply Line—Place the ½" Distribution/Supply Line close to your Potted or Hanging Plants. Use ½" Tube Straps to secure the Tube and install a ½" End Cap.

2 Hole Punch—Punch holes in the ½" Distribution/Supply Line for each container or hanging basket. Next, insert ¼" Barbed Couplers into each hole.

3 Connect ¼" Distribution/Supply Line to each exposed Barbed Coupler and run the Distribution/Supply Line to each container/basket. Use ¼" Tube Straps to hold in place.

IMPORTANT: A single ¼" Distribution/Supply Line should not exceed 30'.

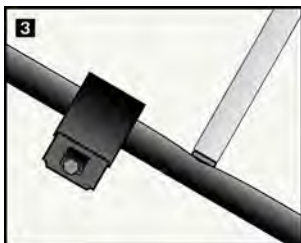
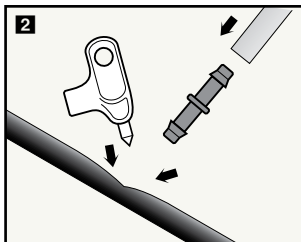

FOR POTTED PLANTS

- 4** Attach Multi-Stream Drippers to each ¼" Distribution/Supply Line and insert stake next to each plant.
- 5** Remove the ½" End Cap and turn on water to flush system; replace cap.
- 6** Adjust water flow by twisting the top of the Multi-Stream Dripper.

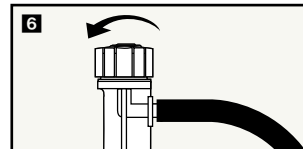
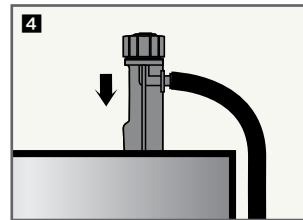

FOR HANGING PLANTS

- 4** Attach Adjustable Flow Mist Sprayers to each ¼" Distribution/Supply Line and aim sprayer into the hanging basket.
- 5** Continue running lines to each hanging basket until the system is completed.
- 6** Remove the ½" End Cap and turn on water to flush system; replace cap.
- 7** Rotate the flow control knob on the Mist Sprayer to adjust flow rate.

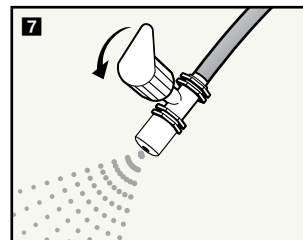
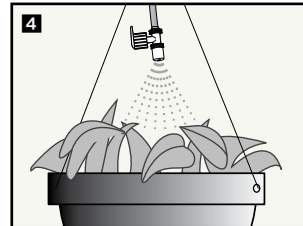

IMPORTANT: The maximum recommended number of Multi-Stream Drippers and Mist Sprayers per ½" supply line is 15.

Supplies needed

- ½" Tube Straps (part # DR-65716-10)
- ¼" Tube Straps (part # DR-65715-20)
- ¼" Distribution/Supply Tube (part # DR-69301-07301)
- ¼" Barbed Couplers (part # DR-40935-10 or DR-97150-10)
- Stake with Multi-Stream Dripper (part # 66105, 67105 or 68105)
- Adjustable Flow Mist Sprayer (part # DR-66190)
- Punch Tool (part # DR-10397-42315)

GROUND COVER & FLOWER BEDS

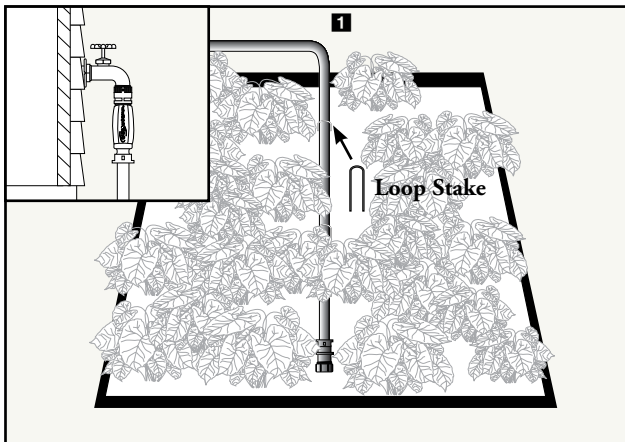

1 Distribution/Supply Line—Lay the ½" Distribution/Supply Line down the center of the Flower Bed or Ground Cover and install a ½" End Cap. Use Loop Stakes to hold in place.

2 Low-Volume Sprinkler—Following the illustrated example, place Quarter-Spray-Pattern Sprinkler Heads in the corners, Half-Spray-Pattern Sprinkler Heads along the sides, and Full-Spray-Pattern Sprinkler Heads in the center of your ground cover.

IMPORTANT: Spacing should be no more than 10' from one sprinkler to the next.

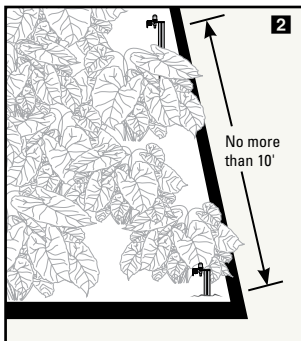

3 Hole Punch—Punch a hole on top of the ½" Distribution/Supply line for each Low-Volume Sprinkler. Next insert a ¼" Barbed Coupler into each hole.

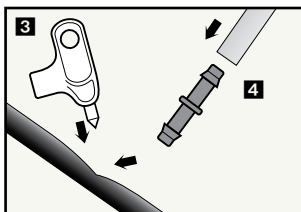

4 Connect the ¼" Distribution/Supply Line to each of the exposed Barbed Couplers and run the Distribution/Supply Line to each sprinkler location. Cut tubing to desired length.

IMPORTANT: Keep Drip-Tubing lengths to less than 30'.

5 Attach the On-Stake Low-Volume Sprinkler to each ¼" Distribution/Supply Line.

6 Remove the ½" End Cap and turn on water to flush system; replace cap.

7 Rotate the flow control knob to adjust flow rate.

IMPORTANT: The maximum recommended number of Low-Volume Sprinklers per ½" supply line is 16 at medium flow setting (8 at the maximum setting)

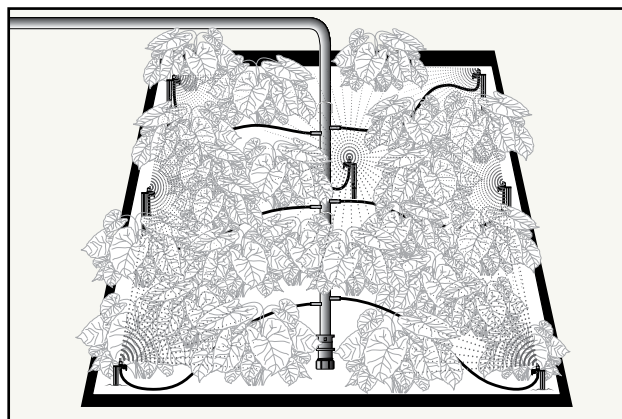
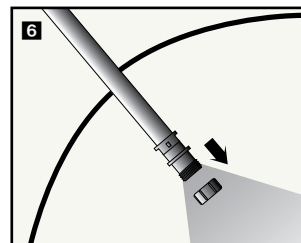
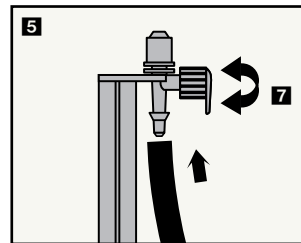

Supplies needed

- ¼" Distribution/Supply Tube (part # DR-69301-07301)
- ¼" Barbed Couplers (part DR-40935-10 or DR-97150-10)
- Low-Volume Sprinkler on Stake (part # 67135, 67136, 67137 or 67138)
- ½" Loop Stake (part # DR-65731)
- Punch Tool (part # DR-10397-42315)

SMALL TREES & SHRUBS

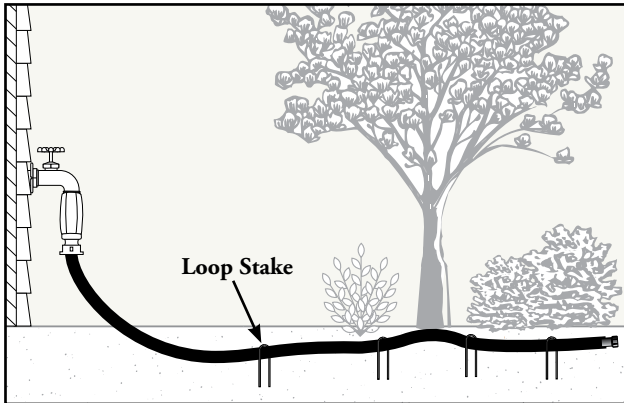

1 Distribution/Supply Line—Lay the 1/2" Distribution/Supply Line next to the base of your plants, shrubs, and trees. Install a 1/2" End Cap at the end of the tubing. Use Loop Stakes to hold in place.

2 Hole Punch—Punch holes on top of the 1/2" Distribution/Supply Line next to the base of each plant, shrub or tree. Insert the barbed end of a 4 GPH Flag Dripper into the hole.

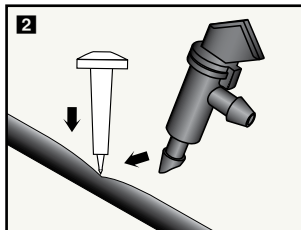

3 If needed, attach 1/4" Distribution/Supply Line to the end of the Flag Dripper and run the 1/4" Distribution/Supply Line to the plant location.

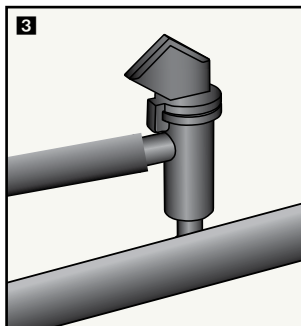

4 Install an insect plug into the end of the 1/4" Distribution/Supply Line.

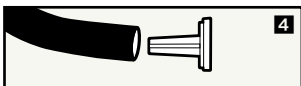

5 Remove the 1/2" End Cap and turn on water to flush system; replace cap.

Note: If your Drip-irrigation system is being installed on non-level ground, replace all 4 GPH Flag Drillers with 1 or 2 GPH Pressure Compensating Drillers to ensure consistent water flow across the entire system.

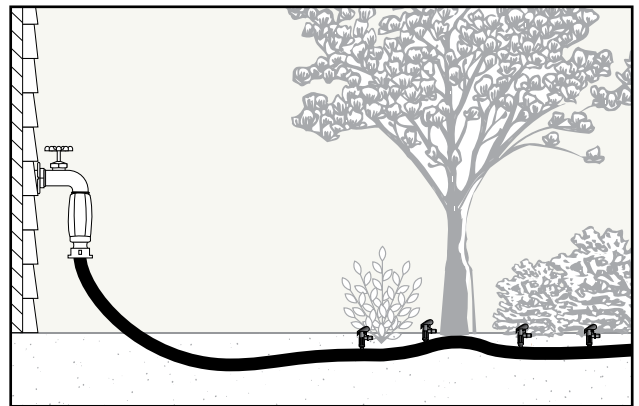
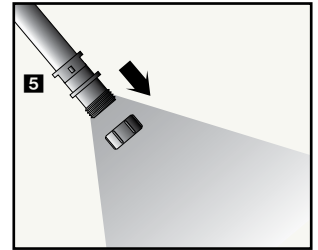

IMPORTANT: The total number of 4 GPH (Gallons per Hour) Flag Drillers attached to a single 1/2" Supply Line should not exceed 45.

Supplies needed:

- Flag Drillers (part # 65201, 66201 or 68201)
- 1/2" Loop Stake (part # DR-65731)
- 1/4" Insect Plug (part # 66405 or 67405)
- Punch Tool (part # DR-10397-42315)

CONNECTING TO AN EXISTING UNDERGROUND SPRINKLER SYSTEM

Connecting to an existing underground sprinkler system (or Retrofit) is a simple way to supply water to your Drip-Irrigation system. Retrofits are commonly used to conserve water by replacing inefficient shrub sprinklers and bubblers.

Retrofit Drip-Irrigation systems consist mainly of

- 1** Manifold—Attaches to a ½" riser and consists of 1 to 8 outlets.
- 2** ¼" Distribution/Supply Line
- 3** Low-Volume Sprinkler, Dripper, or Soaker Tube

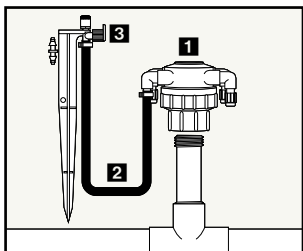

MANIFOLDS

The main function of a Manifold is to distribute water through ¼" outlets.

There are 4 types of Manifolds

- 1 Adjustable Flow Manifolds**—Ideal when water system pressures exceeds 40 PSI and where flow control is desired.
- 2 Full Flow Manifolds**—Ideal for replacing inefficient shrub heads and bubblers.
- 3 Shrub Adapter**—Ideal for micro-sprinklers.
- 4 Riser Adapter Manifolds**—Permits Drip-Irrigation without eliminating a sprinkler head.

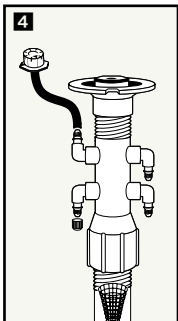
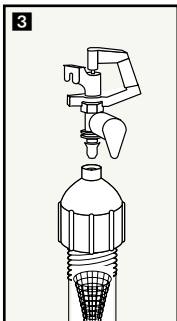
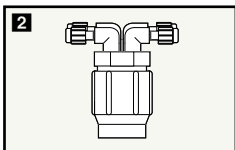
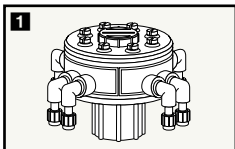

INSTALLATION FOR ADJUSTABLE-FLOW, FULL-FLOW, AND RISER ADAPTER MANIFOLDS

- 1** Remove sprinkler head from a ½" Riser and attach the manifold. (For Riser Adapter Manifold, reattach sprinkler head).
- 2** Remove Cap(s) from the ¼" Barb(s) and insert ¼" Distribution/Supply Line.
- 3** Attach a Low-Volume Sprinkler or Drip-Irrigation Dripper to the end of the Distribution/Supply Line.
- 4** To avoid high water pressure failure, install a ¼" High Pressure Clamp on all tube connections.
- 5** Position Drip-Irrigation Dripper next to plant.
- 6** If applicable, adjust flow-control knob for desired flow rate.

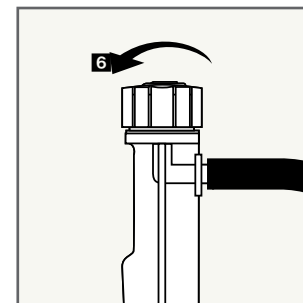
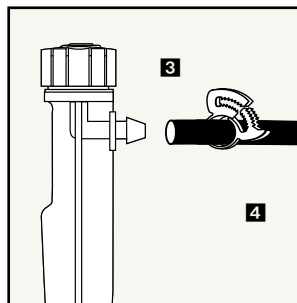
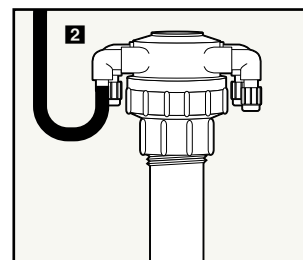
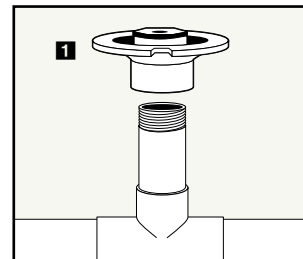

COMMON RETROFIT PROJECTS

1. **Container Plants and Shrubs**—page 16
2. **Shrubs and Large Plants**—page 19

CONTAINER PLANTS AND SHRUBS

Replacing hand watering with Drip-Irrigation

- 1 Connect an 8-Port or 4-Port Adjustable Manifold to an exposed shrub riser. If a vacant riser is not available, use a Saddle Adapter to connect to the sprinkler line.
- 2 Remove Caps and attach ¼" Distribution/Supply Line to each ¼" Barb.

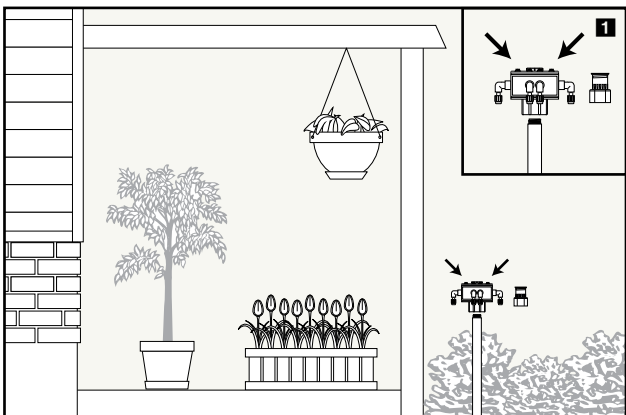

- 3 Run each ¼" Distribution/Supply Line to each container. Use ¼" Tube Straps to hold tube in place. (Window boxes and large containers may require more than one line.)

IMPORTANT: A single ¼" Distribution/Supply Line should not exceed 30'.

- 4 Flush lines to clear any debris.
- 5 Select the appropriate Drip-Irrigation Dripper for each container and plant.

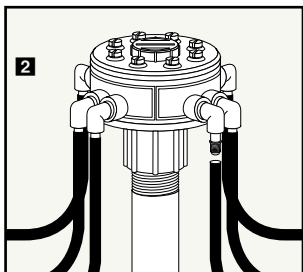

HANGING BASKETS AND WINDOW BOXES

Use FlexMist[®] (part # DR-66190) or Adjustable Mist Sprayer (part # DR-67191).

POTTED PLANTS

Use Multi-Stream on a Stake (part # DR-31295, DR-31495)

SHRUBS

Use Low-Volume Sprinkler Head on 12" Stake. (See Parts List at end of manual for spray pattern options)

- 6 Adjust the flow rate by turning the flow control screw.

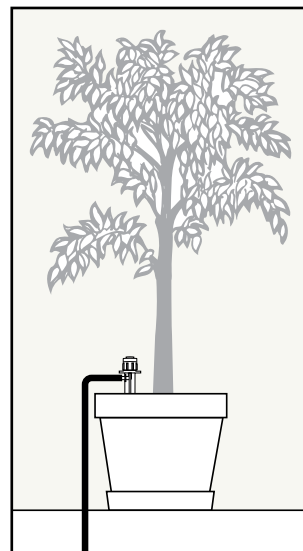
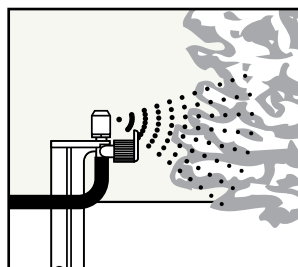
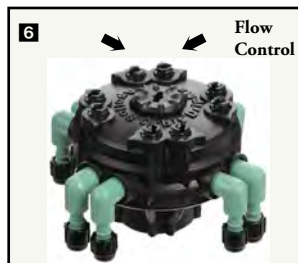
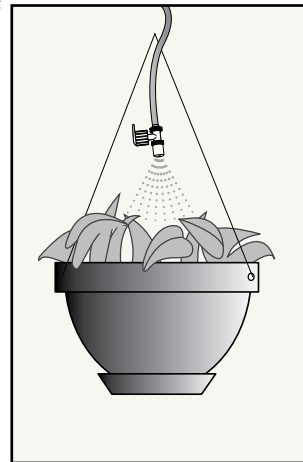

Continued on next page

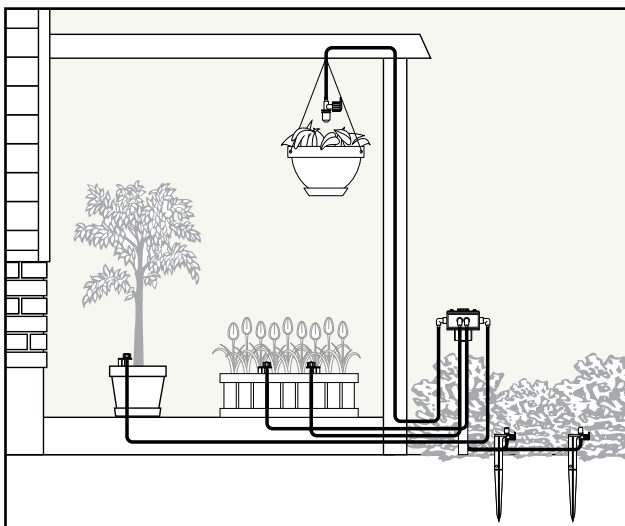

Supplies Needed

- 8-Port Adjustable Manifold (part # DR-67000)
- Or
- 4-Port Adjustable Manifold (part # DR-67005)
- The appropriate Drip-Irrigation Sprinkler listed above
- ¼" Tube Straps (part # DR-65715-20)
- ¼" Distribution/Supply Tube (part # DR-69301-07301)

FLOWER BEDS, GROUND COVER, SHRUBS AND LARGE PLANTS

Replacing inefficient shrub heads with Drip-Irrigation

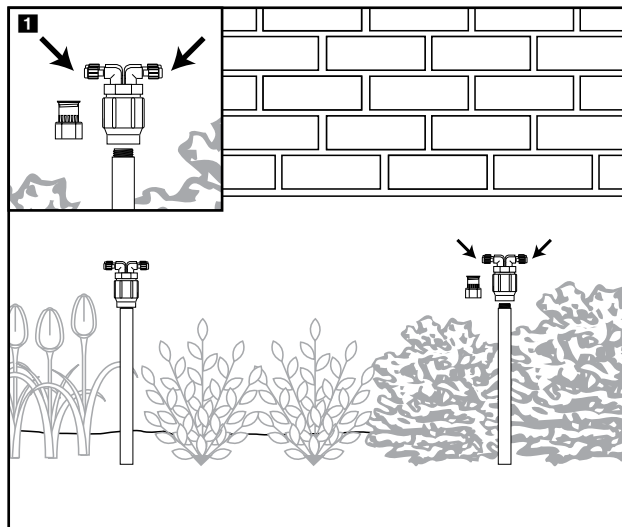

1 Remove shrub heads from risers and replace with "Full-Flow 4-Port Manifolds."

2 Remove Barb Caps from the manifolds and attach ¼" Distribution/Supply Lines to each exposed ¼" Barb. Run individual ¼" Distribution/Supply Line to each Low-Volume Sprinkler Head. Flush lines to clear any debris.

IMPORTANT: Full-Flow Manifolds do not have an internal pressure regulator. To avoid high pressure failures install ¼" High Pressure Clamps on all ¼" connections.

IMPORTANT: A single ¼" Distribution/Supply Line should not exceed 30'.

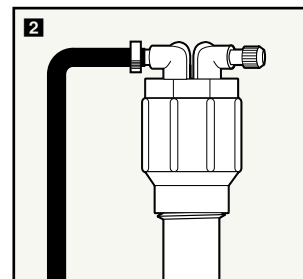

Continued on next page

FLOWER BEDS AND GROUND COVER

Attach a Low-Volume Sprinkler Head on 12" Stake, spaced no more than 10' apart. (See Parts List for spray pattern options)

OR

Multi-Stream Dripper on a stake, spaced no more than 3' apart.
(part # DR-31295, DR-31495, DR-30995)

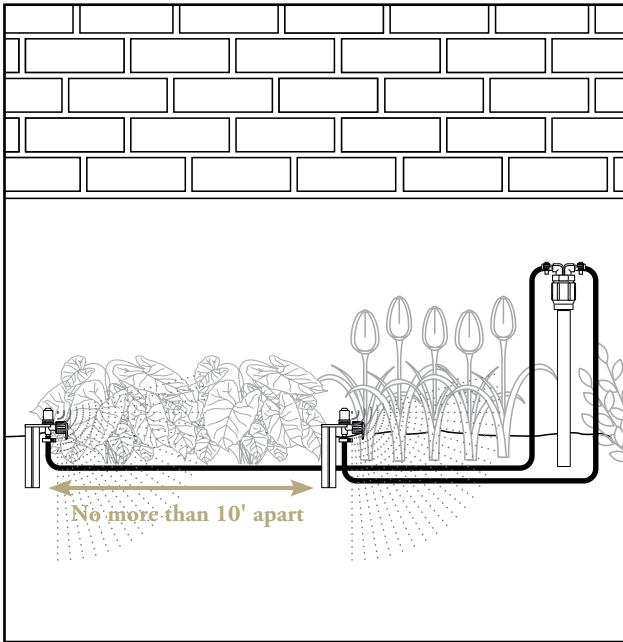

Note: Adjust the flow rate by turning the flow control on each Drip-Irrigation sprinkler head.

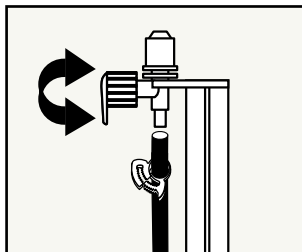

SHRUBS AND LARGE PLANTS

Use Multi-Stream Dripper on a Stake next to each shrub or large plant.
(part # DR-31295, DR-31495, DR-30995)

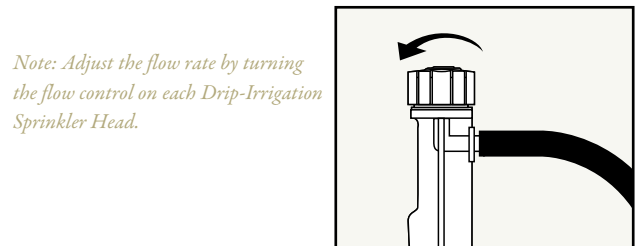
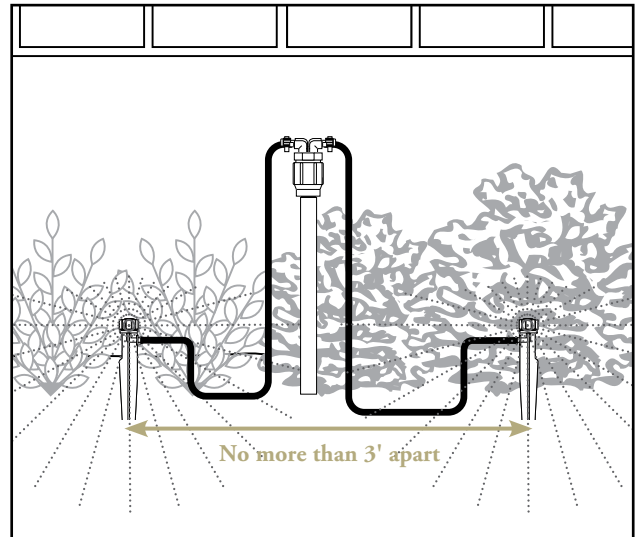

Note: Adjust the flow rate by turning the flow control on each Drip-Irrigation Sprinkler Head.

Supplies needed:

- Full-Flow 4-Port Manifold (part # DR-67025)
- The appropriate Drip-Irrigation sprinkler head listed above
- ¼" Distribution/Supply Tube (part # DR-69301-07301)
- ¼" High Pressure Clamps (part # DR-67710)

CONNECTION TO A DESIGNATED IRRIGATION VALVE

Direct connection to an underground irrigation valve is ideal for medium to large Drip-Irrigation projects. This application is most commonly used for gardens, large flower beds, shrubs, trees, and desert landscaping.

IMPORTANT:

- Contact the local water district for code requirements.
- Before digging, contact utility companies to mark utility lines.

Connection to a designated valve consists of

- 1 ¾" Irrigation Valve (manual or automatic)
- 2 Y-Filter (model DR-69736)

Note: Using a filter not designed for Drip-irrigation, may cause damage.

- 3 ½" Distribution/Supply Tubing (part # DR-67346-69346) or ¾" Polyethylene or PVC Pipe

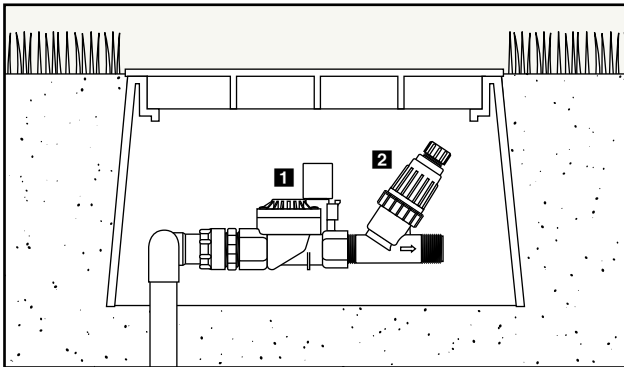

COMMON APPLICATIONS

1. Gardens—page 23
2. Desert Landscaping—page 25

GARDENS

1 Water Supply—Connect ¾" PVC to the end of the Y-Filter and run the PVC pipe down the center of the garden. Attach a ¾" Slip x ½" Threaded Tee for each row. Use an Automatic Drain Valve on the end of the pipe and on any low sections of the PVC pipe.

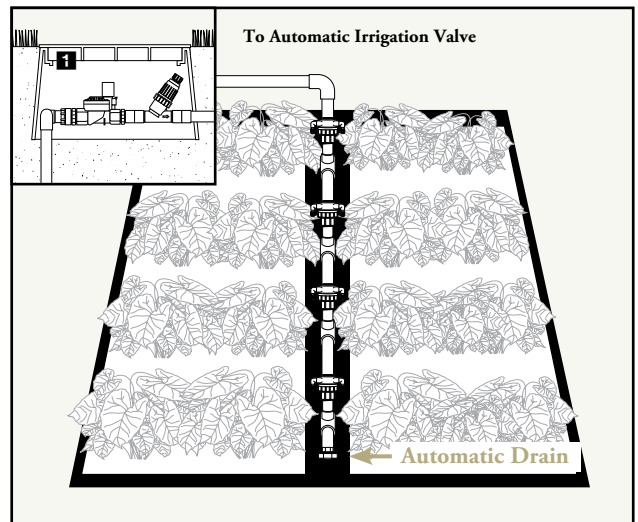

2 Screw in ½" Risers on each Tee (extending 6" to 8" above ground). Attach an Orbit® 4-Port Adjustable Manifold on each riser.

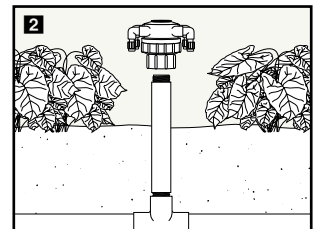

3 Remove manifold caps and attach ¼" Soaker Tube to each ¼" Barb. Run Soaker Tube along the base of each plant.

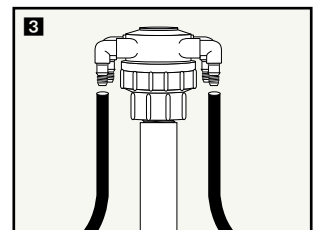

Tip—Use Metal Loop Stakes to hold the ¼" Soaker Tube in place.

- 4** Cut Soaker Tube to desired length and insert a ¼" End Plug.

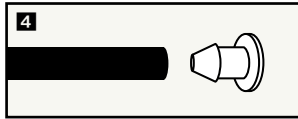

Note: Keep each ¼" Soaker Tube length to less than 15'.

- 5** Remove the Automatic Drain Valve, attached to the end of the PVC pipe and flush the line to remove any debris.

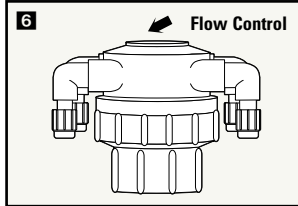

- 6** Adjust the flow rate by turning the Flow Control Screw.

IMPORTANT: Do not attach more than 14 4-Port Manifolds

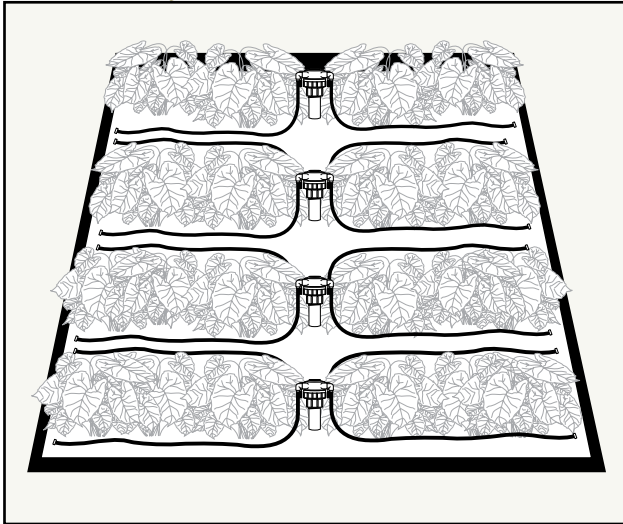

Supplies Needed

- ½" Automatic Drain Valve (part # OP-94561-51240)
- 4-Port Adjustable Manifold (part # DR-67005)
- ¼" Loop Stakes (part # DR-65730)
- ¼" Soaker Tubing (part # DR-69330)
- ¼" End Plugs (part # DR-67403)
- PVC Fitting: ¾" Slip x ½" Threaded Tees OR Insert Poly Fitting
- ½" Risers

DESERT LANDSCAPING

- A** Irrigation Valve
- B** Pressure Compensating Dripper with a Tube Stake
- C** Loop Stake
- D** End Cap

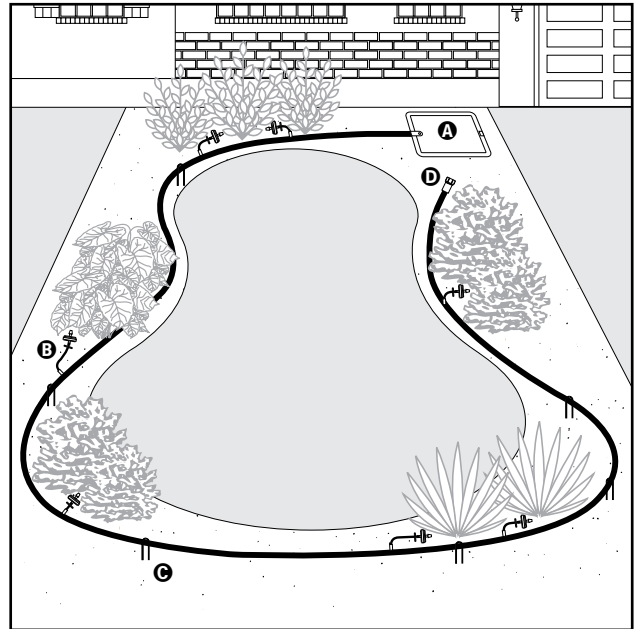

- 1** Water Supply—Connect a Pressure Regulator (part # DR-67740) to the Y-Filter and attach a Male Adapter (part # OP-67454 or OP-37305). Next attach ½" Distribution/Supply line to the exposed end. (See the top of page 26)

IMPORTANT: Use a Pressure Regulator to avoid damage to the Drip-Irrigation system.

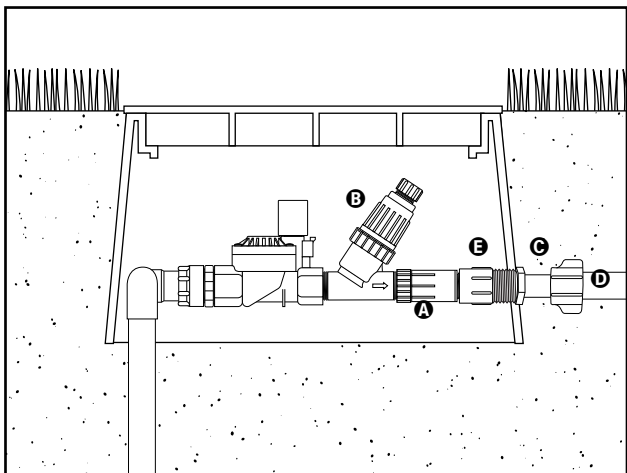

- A** Pressure Regulator
- B** Y-Filter
- C** Male Adapter
- D** 1/2" Distribution/Supply Line
- E** Threaded Coupler (sold separately)

2 Run Distribution/Supply Line next to plants, shrubs and trees you intend to water. Next install a 1/2" End Cap. Use 1/2" Loop Stakes to hold the line in place.

3 Hole Punch—Punch a hole in the 1/2" Distribution/Supply Line for each shrub or tree. Next insert a 1/4" Barbed Coupler into each hole.

4 Connect the 1/4" Distribution/Supply Line to each of the exposed Barbed Couplers and run it to the base of each shrub or tree. Cut tubing to desired length.

IMPORTANT: A single 1/4" Distribution/Supply Line should not exceed 30'.

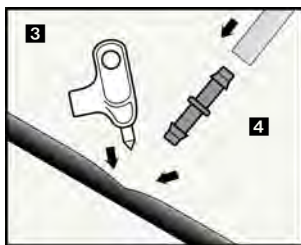

5 Remove the 1/2" End Cap and turn on water to flush 1/2" Distribution/Supply Line, then replace cap to flush 1/4" Distribution/Supply Lines.

6 Attach a Pressure Compensating Dripper to each 1/4" Distribution/Supply Line. To hold dripper in place, next to the base of the shrub or tree, use a Tube Stake.

Note: More than one 1/4" Distribution/Supply Line (with Pressure Compensating Dripper) may be required for large trees or shrubs.

IMPORTANT: Do not attach more than 57 2-GPH Pressure Compensating Drippers to a single 1/2" Distribution/Supply Line

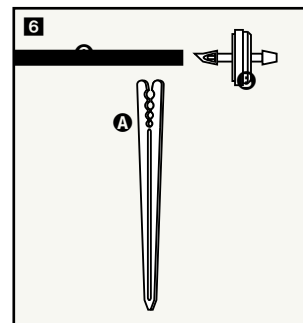
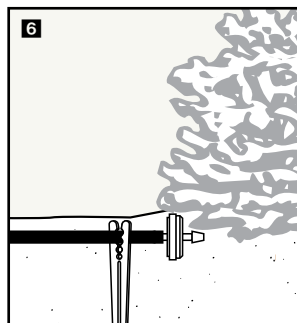
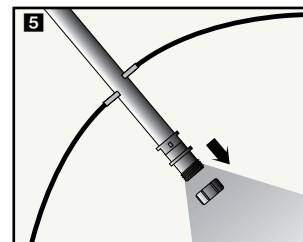

- A** Tube Stake
- B** Pressure Compensating Dripper
- C** 1/4" Distribution/Supply Line

Supplies needed:







- 1/2" Male Adapter (part # OP-67454 or OP-37305)
- 1/2" Distribution/Supply Tubing (part # DR-67346-69346)
- 1/2" End Cap (part # OP-67462)
- 1/2" Loop Stake (part # DR-65731)
- Punch Tool (part # DR-10397-42315)
- 1/4" Barbed Couplers (part # DR-40935-10 or DR-97150-10)
- 1/4" Distribution/Supply Tube (part # DR-69301-07301)
- Tube Stakes (part # DR-65721-10)
- Pressure Compensating Dripper (part # DR-67205, DR-67206)

NOTES

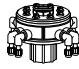
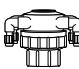

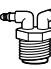
Micro-Irrigation Parts List

SECTION 9





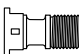

MANIFOLDS

- Adjustable Flow  8-Port Manifold
DR-67000
-  4-Port Manifold
DR-67005
-  4-Port Manifold
DR-67025
- Full Flow  1/2" MPT
2-Port Manifold
DR-67035
-  2-Port Manifold
DR-66030
-  1/2" Female Pipe
Threaded Shrub
Adapter with
Threaded Outlet
DR-41015
- Riser Adapter Manifold  1/2" Riser Adapter
with 1/4" Barb
DR-67035
-  4-Port Adapter
Manifold
DR-67060

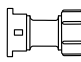
PIPE THREAD

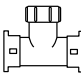
-  Y-Filter
3/4" Male Pipe
Thread
DR-69736
-  Pressure Regulators
25 PSI—3/4" Pipe
Threaded
DR-67740
-  1/2" Pipe Thread
Adapter
OP-67454

FAUCET

-  3-in-1 Faucet
-Adapter Filter
-Pressure Reducer
-1/2" Tubing
Adapter
OP-67339
-  Faucet Adapter
1/2" Distribution
Tube
OP-67455
-  Faucet Adapter
1/4" Distribution
Tubing
DR-67432
-  Hose Thread
Swivel x 1/2"
Tubing Tee
OP-67456
-  Pressure Regulators
25 PSI—Hose
Threaded
DR-67741
-  Hose Bib Anti-
Siphon Valve
OP-67750
-  Plastic Hose-Y
OP-58085

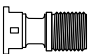
-  3/4" Pipe Thread
Adapter
OP-37305

LOW VOLUME SPRINKLER



Mini Rotating Sprinkler
DR-20205



Low-Volume Sprinkler
Full 66116, 67116
1/2 66117, 67117
1/4 66118, 67118
Strip 66115, 67115

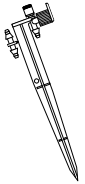

Low-Volume Sprinkler Head on 12' Stake
Full 67136
1/2 67137
1/4 67138
Strip 67135



Adjustable Mist Sprayer
DR-67191

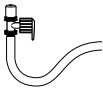

Adjustable FlexMist™
DR-66190

DRIPPERS AND BUBBLERS



Multi-Stream Dripper
DR-31245
DR-31445

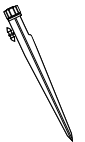

Multi-Stream on a Stake
DR-31295
DR-31495
DR-30995



Flag Dripper
2 GPH 65200, 66200
4 GPH 65201, 66201, 67201



Pressure Compensating Dripper
1 GPH DR-67205
2 GPH DR-67206

DISTRIBUTION TUBE FITTINGS



Barb Elbow
DR-67400



Barb Tee
DR-67401

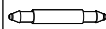

Barb Coupling
DR-67402



Barb End Plug
DR-67403



Barb Shut-Off Valve
DR-67404

1/4" Distribution Tube Connectors



Coupler
OP-67451



Tee
OP-67452



Elbow
OP-67450



End Cap
OP-67462



Shut-Off Valve
OP-67463

1/2" Distribution Line Connectors fits .690 to .710 drip tubing

Universal 1/2" Distribution/Supply Line Connectors



Hose/Faucet Adapter
DR-10813



Male Hose Threaded Adapter
DR-10809



3/4" Male Pipe Threaded Adapter
DR-10811



Coupler
DR-10815



Elbow
DR-10801



Tee
DR-10803



End Cap
DR-10800

DISTRIBUTION/SUPPLY TUBE



1/4" Distribution Tube
100' DR-69301-07301



1/2" Distribution Tube
100' DR-67346-69346
500' DR-67347-69500

1/4" SOAKER TUBE

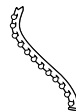

Dripline 100'
DR-12930-SHB106
DR-12936-SH106



1/4" Porous Soaker Tube
50' DR-69330

1/4" SOAKER TUBE



Extension Riser 8" or 12"
DR-50125
DR-50135



12" Tubing Stake
DR-10404

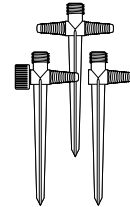

3/4" Female Hose Thread x 1/2" Barbed-Stake
OP-67990



1/2" Barbed Inline x Male Pipe Thread-Stake
OP-67991



1/2" Barb x Male Pipe Thread-Stake
OP-67992



Tubing Holder Stake
DR-65721-10



Loop Stake
1/4" DR-65730
1/2" DR-65731



Tubing Strap
1/4" DR-65715-20
1/2" DR-65716-10



1/4" High Pressure Clamp
DR-67710



Tube Punch Tool
DR-10397-42315